



GSK CNC Equipment Co.,Ltd.-China Southern CNC Industrial Base



GSK's Second Industrial Park - Precision Part Machining Park



GSK's Third Industrial Park - Robot Industrial Park

GSK CNC Equipment Co., Ltd. (hereinafter referred to as GSK) is specially devoted to conducting research and practice of basic equipment industrial development, providing "trinity" packaged solutions of machine tool CNC system, servo drive and servo motor, taking initiative in the expansion of industrial robot and all-electric injection molding machine field, developing the new marketing mode of machine tool exhibition hall, providing the customers with all-round professional machine tool remanufacturing solutions and services, promoting the integration of production and education, setting up the vocational education and training institute, as well as conducting highly skilled CNC personnel training. It has developed into a high-tech enterprise integrating science, education, industry and trade, thus being known as "China Southern CNC Industrial Base" .

Adhering to the corporate philosophy of "making itself a century-old enterprise and building gold quality" and the service spirit of "keeping improvement and making users satisfied" , GSK enhances the user product value & benefits through continuous technological progress and innovation, and makes unremitting efforts to promote the localization process of basic equipment industry, improve the technological level of the industry, and promote the development of China's national equipment manufacturing industry.

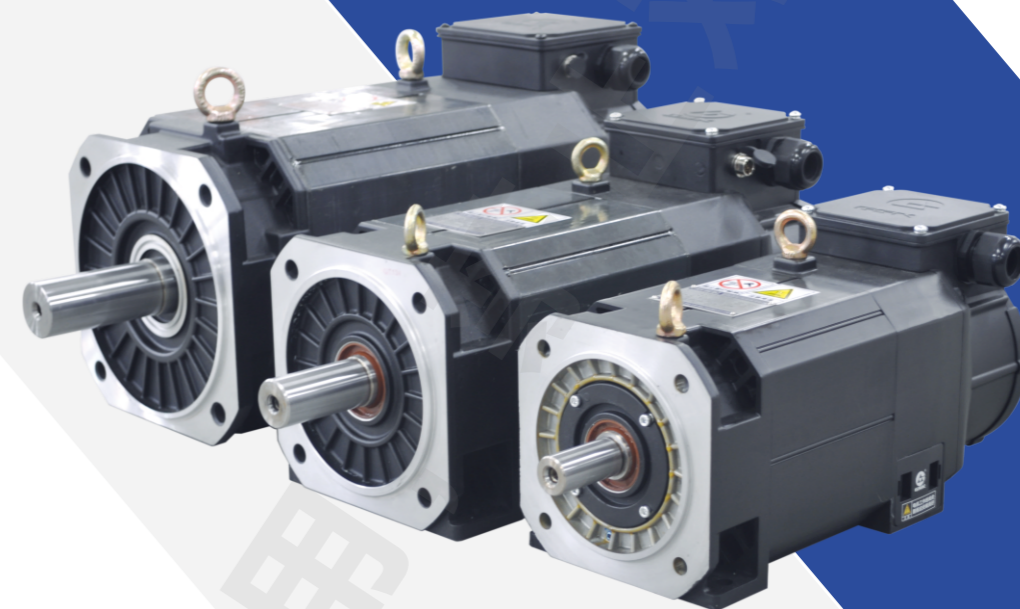

## GSK ZJY serial

Spindle Servo Motor

COMMAND THE FUTURE

**GSK CNC EQUIPMENT CO., LTD.**

CNC System Marketing Center

Web: [Http://www.gsk.com.cn](http://www.gsk.com.cn)

Add: No.22 Guanda Road, Luogang District, Guangzhou, China

Postcode: 510530

Sales: 020-81797922













## Technical specifications

The main technical parameters of Double speed motor and its overall dimension(List 3)

ITEM	SPEC.		ZJY265A-4.4VMD		ZJY265A-6VMD		ZJY265A-7.5VMD		ZJY265A-9VMD		
	Y (Low speed coil)	Δ(High speed coil)	Y (Low speed coil)	Δ(High speed coil)	Y (Low speed coil)	Δ(High speed coil)	Y (Low speed coil)	Δ(High speed coil)	Y (Low speed coil)	Δ(High speed coil)	
Mode of Winding connection	Y (Low speed coil)	Δ(High speed coil)	Y (Low speed coil)	Δ(High speed coil)	Y (Low speed coil)	Δ(High speed coil)	Y (Low speed coil)	Δ(High speed coil)	Y (Low speed coil)	Δ(High speed coil)	
Rated power ( kW )	4.4	5.5	6	7.5	7.5	9	9	11			
Adapted Driver	GS/GR3075		GS/GR3075		GS/GR3100		GS/GR3150				
Drive power supply(V)	Three-phase AC 380V/440V 50/60Hz										
Rated current ( A )	12.9	21.9	17.6	30.1	23.6	39.2	27.8	46.7			
Rated frequency ( Hz )	21.8	26.8	21.9	26.9	21.8	26.7	21.8	26.7			
Rated torque ( N · m )	70	70	95.5	95.5	119	115	143	140			
30min power ( kW )	8	7.5	11	9	13.5	11	18	15			
30min current ( A )	22.2	27.1	29.8	34.3	36	47.7	47	58.8			
30min torque ( N · m )	127	95.5	175	115	214	140	286	191			
Rated speed ( r/min )	600	750	600	750	600	750	600	750			
Max. speed ( r/min )	1500	7000	1500	7000	1500	7000	1500	7000			
Moment of inertia(kg.m <sup>2</sup> )	0.0599		0.0734		0.0878		0.1043				
Weight ( kg )	107		125		143		162				
Installation type	IM B5 or B3										
Cooling fan power	Three phase AC 380V/440V 50/60Hz 70W 0.21A										
Overall dimension (refer to figures)	A	265	265	265	265	265	265	265	265	265	
	B	132	132	132	132	132	132	132	132	132	
	C	185	185	185	185	185	185	185	185	185	
	D	265	265	265	265	265	265	265	265	265	
	E	110	110	110	110	110	110	110	110	110	
	F	487	532	577	632	632	632	632	632	632	
	G	347	392	437	492	492	492	492	492	492	
	H	230h7	230h7	230h7	230h7	230h7	230h7	230h7	230h7	230h7	230h7
	I	14	14	14	14	14	14	14	14	14	14
	J	48h6	48h6	55h6	55h6	55h6	55h6	55h6	55h6	55h6	55h6
	K	256	256	256	256	256	256	256	256	256	256
	L	135	135	135	135	135	135	135	135	135	135
	N	230	230	230	230	230	230	230	230	230	230
	P	40	40	40	40	40	40	40	40	40	40
	Q	270	315	360	415	415	415	415	415	415	415
	S	110	110	110	110	110	110	110	110	110	110
T	5	5	5	5	5	5	5	5	5	5	
Z	15	15	15	15	15	15	15	15	15	15	

## Motor overall and installation dimension

### Installation of the motor

If the motor should run at the speed above 2000r/min, it's recommended to use the motor of optic axis and the pulley is fixed by the expansion sleeve. And the pulley and the expansion sleeve must reach G1 requirements after the dynamic balancing process; otherwise, the big vibration occurs during running at high speed.

### B5 flange installation mode (or use B35 flange installation mode)

ZJY182 series uses M10 × 35 bolt or HEX screw. During using the HEX screw, the length of the internal hexagonal wrench should be more than the total length of the motor and the wrench can be made by the user. Take down the rubber plug on the fan cover and fasten the screw from the back side, and then, push the rubber plug. Use M12 × 45 bolt or HEX screw on ZJY208A or ZJY265A series motor. Use M16 × 60 bolt or HEX screw on ZJY320 series motor.

### B3 footing installation mode ( Or use B35 footing installation mode )

Firstly remove the covers on the sides of back cover during installation. If it is B35 structure, the rubber plug should be also taken down from the footing hole. M10 × 30 HEX screw is used on ZJY182 and ZJY208A series motor , M12 × 40 HEX screw is used on ZJY265A series motor, M16 × 55 HEX screw is used on ZJY320 series motor.

ZJY182A series : Flange installation type ( B5 )

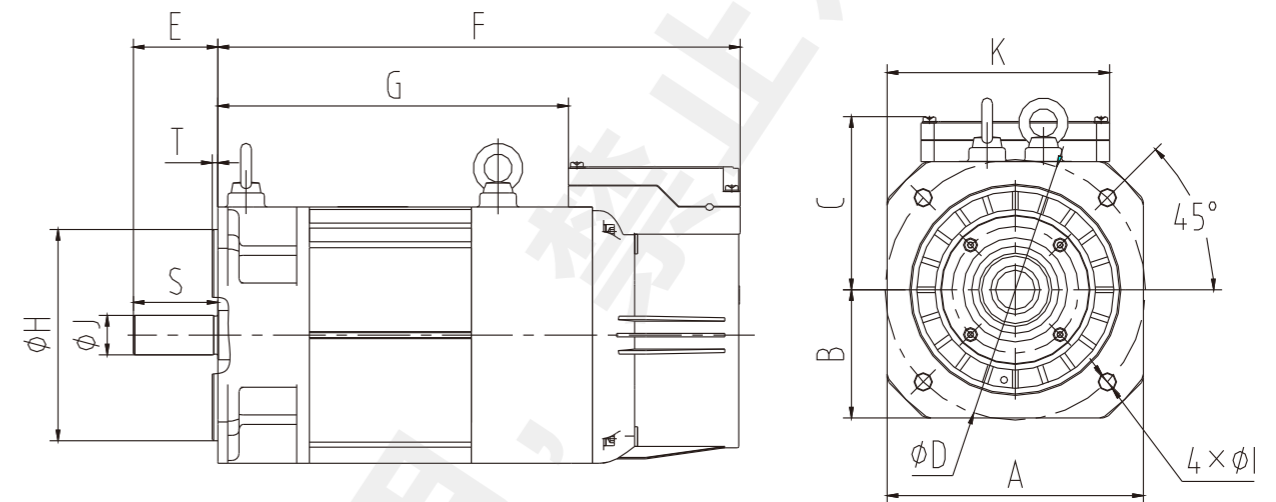

ZJY182A series : Flange & footing installation type ( B35 ) and left & right outlet method

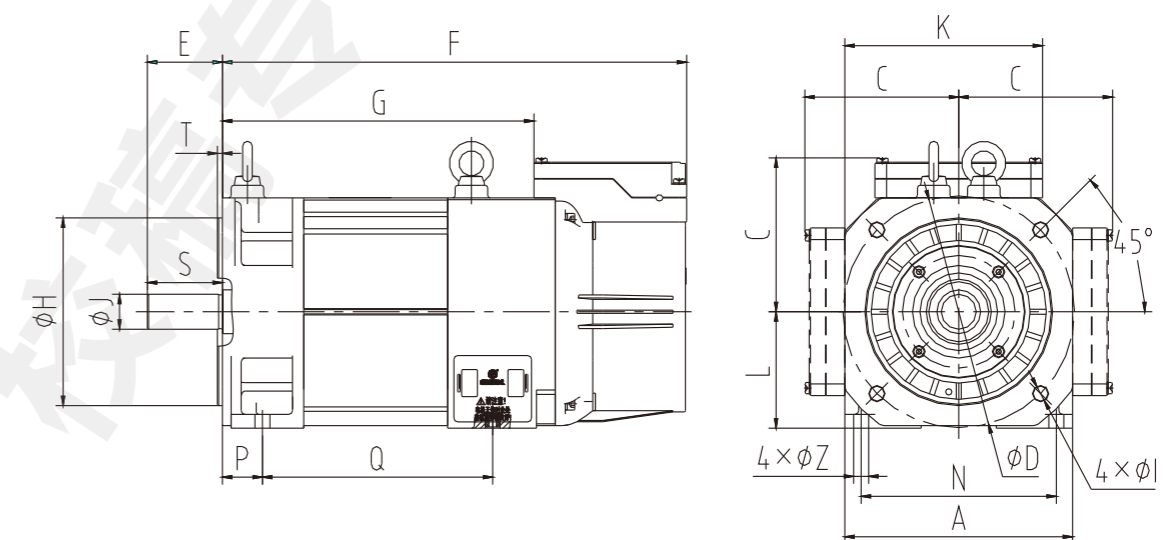



## Motor overall and installation dimension

ZJY208A series and ZJY265A series : Flange installation type(B5)

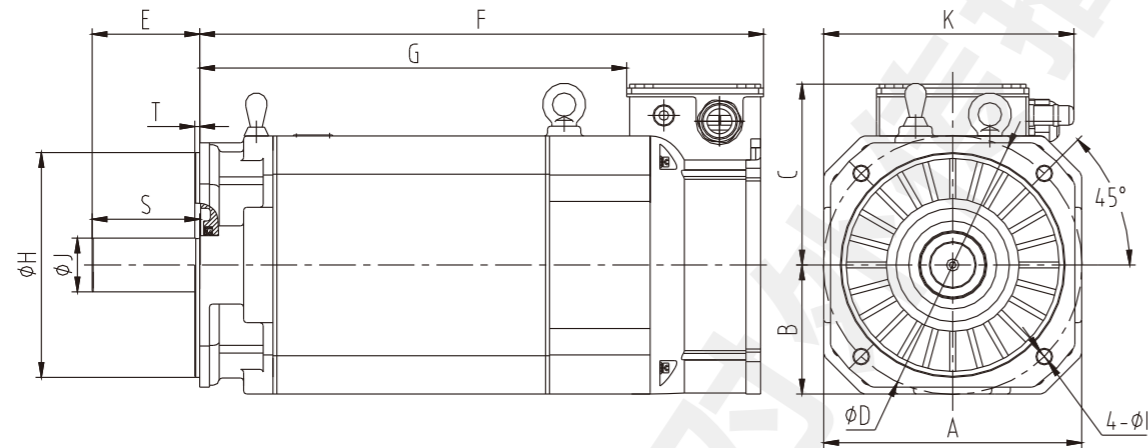

ZJY265A series : Footing installation type (B3) and left & right outlet method

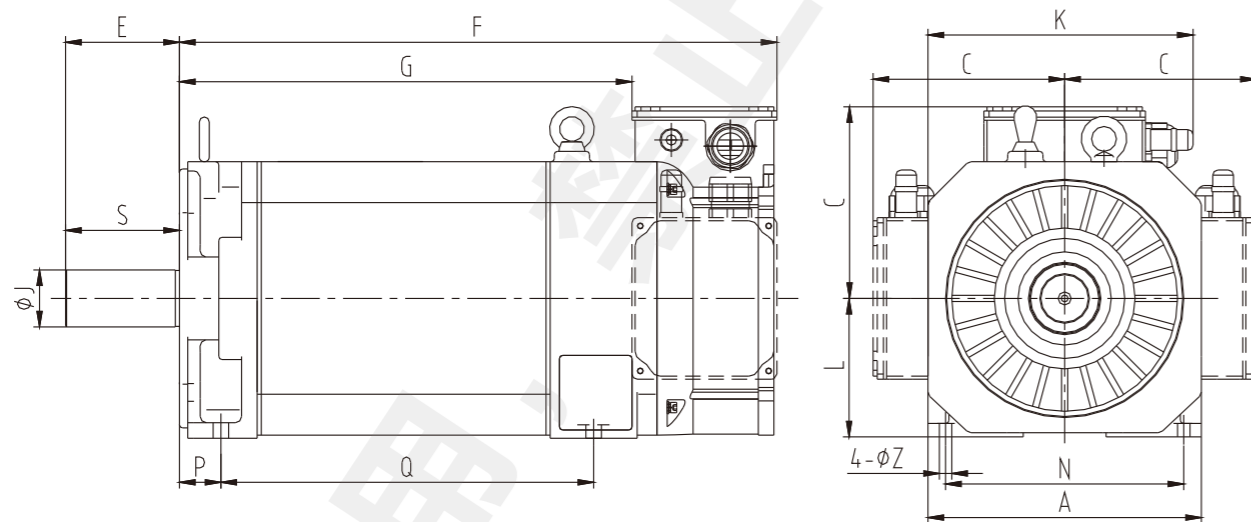

ZJY208A series and ZJY320 series : Flange & footing installation type (B35) and left & right outlet method

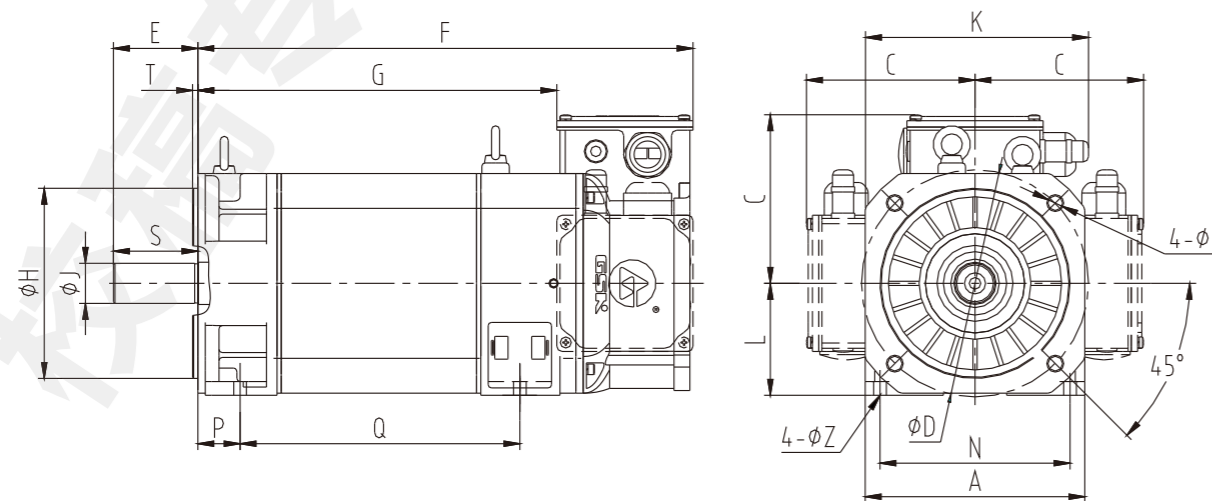

## Motor overall and installation dimension

Because the spindle motor speed is very high, the rotary parts should reach the corresponding dynamic balance requirement; otherwise, it causes the big vibration and noise, even the motor and equipment get damaged. When the rotor of the spindle motor is dispatched from the factory, its dynamic balance precision should reach G0.4 at the speed of 6000r/min. And the user should pay attention to the following points:

- It's recommended to use the spindle motor with the optic axis;
- The pulley must adopt the dynamic balance processing, and its precision should reach G1 or higher (the amount of unbalance in one side should be less than 50mg.) when the speed is 6000r/min. Moreover, the weight of fixed screws should be same. Compared with the concentricity of the shaft, the installed clamping ring should NOT be more than 0.1mm;
- If the user has to adopt the key connection method, the pivot axis of dynamic balance should be made based on the spindle motor shaft end and the key dimension and material, and the pivot axis is for the pulley dynamic balance, and the dynamic balance precision is same as above. The pulley can be press mounted through the screw on the bolt hole at the motor shaft end, or the pulley is shrinkage installed, but it's not allowed to hit the pulley.
- If the required dynamic balance equipment isn't available for the user temporarily, the user can entrust GSK with the pulley balance processing and installation.

## Dimension of the Standard Key Slot

- ZJY182A-3.7BL, ZJY182A-5.5BL, ZJY208A-3.7BM, ZJY208A-2.2AM

The configuration keys: GB/T 1096 key 8×7×50

About the dimension of the shaft end key slot, refer to the following figure; and the central screw hole dimension on the end face of the rotary axis is M10×20.

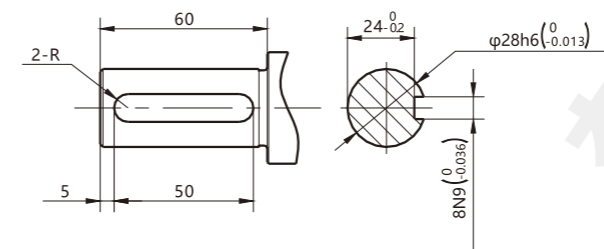

- ZJY208A-5.5BM, ZJY208A-7.5BM, ZJY208A-3.7AM, ZJY208A-3.7WL, ZJY208A-5.5AM, ZJY208A-5.5BL, ZJY208A-7.5BL

The configuration keys: GB/T 1096 key 10×8×70

About the dimension of the shaft end key slot, refer to the following figure; and the central screw hole dimension on the end face of the rotary axis is M10×20.

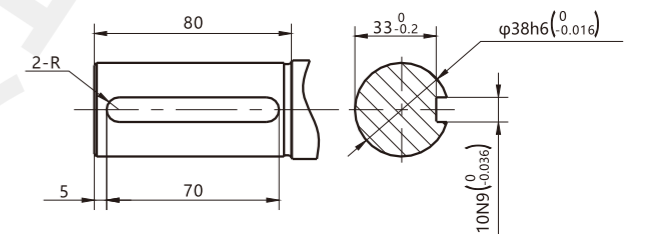

- ZJY265A-5.5WL, ZJY265A-7.5WL, ZJY265A-7.5BM, ZJY265A-11BM, ZJY265A-15BM, ZJY265A-7.5AM, ZJY265A-11AM, ZJY265A-15AM, ZJY208A-11CM, ZJY208A-9BL, ZJY265A-4.4VMD, ZJY265A-6VMD

The configuration keys: GB/T 1096 key 14×9×90

About the dimension of the shaft end key slot, refer to the following figure; and the central screw hole dimension on the end face of the rotary axis is M10×20.

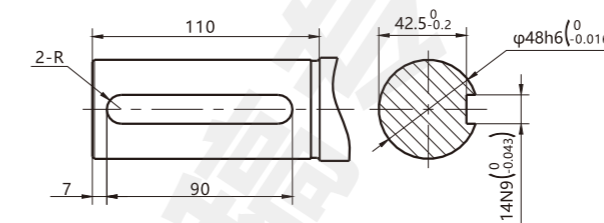

- ZJY265A-11WL, ZJY265A-18.5BM, ZJY265A-22BM, ZJY265A-7.5VMD, ZJY265A-9VMD

The configuration keys: GB/T 1096 key 16×10×90

About the dimension of the shaft end key slot, refer to the following figure; and the central screw hole dimension on the end face of the rotary axis is M10×20.

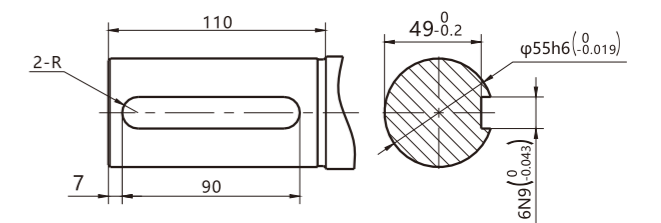

- ZJY320-18.5WL, ZJY320-22WL, ZJY320-30BL, ZJY320-37BL, ZJY320-45BL

The configuration keys: GB/T 1096 key 18×11×110

About the dimension of the shaft end key slot, refer to the following figure; and the central screw hole dimension on the end face of the rotary axis is M10×20.

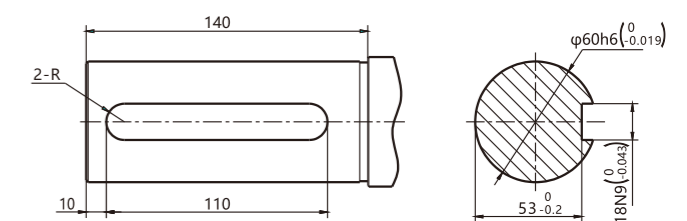

## Mechanical characteristics curve of the motor

## Mechanical characteristics curve of the motor

— Power or torque in the continuous working state;

---- Power or torque in 30min working state.

ZJY182A-3.7BL

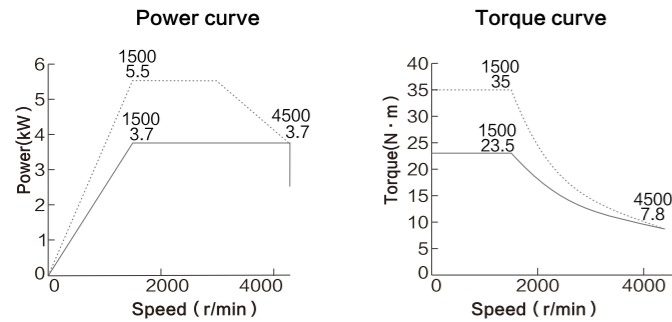

ZJY182A-3.7BH

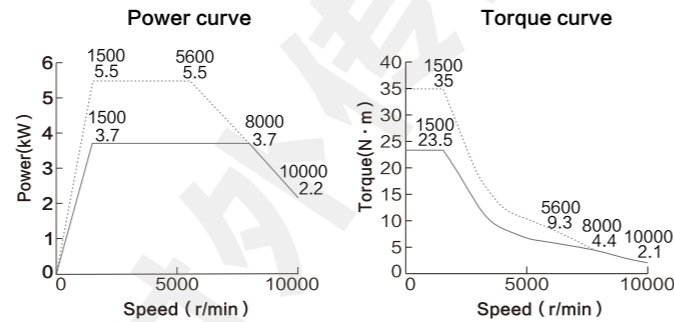

ZJY182A-7.5EG

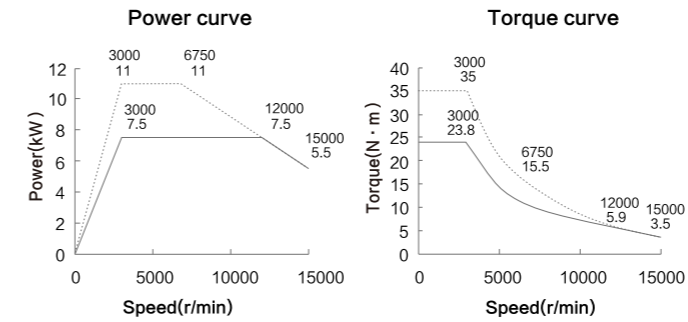

ZJY208A-5.5AM

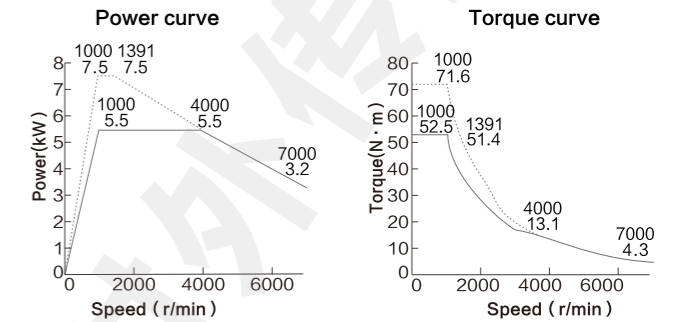

ZJY182A-5.5BL

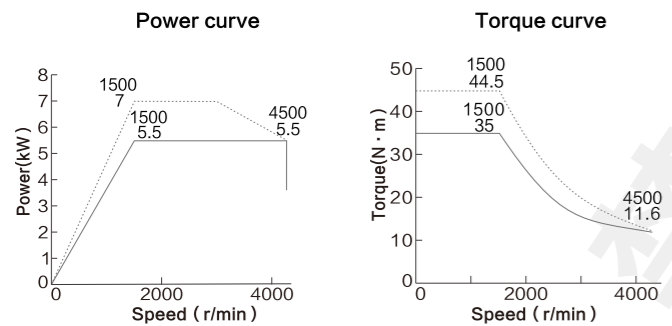

ZJY182A-5.5BH

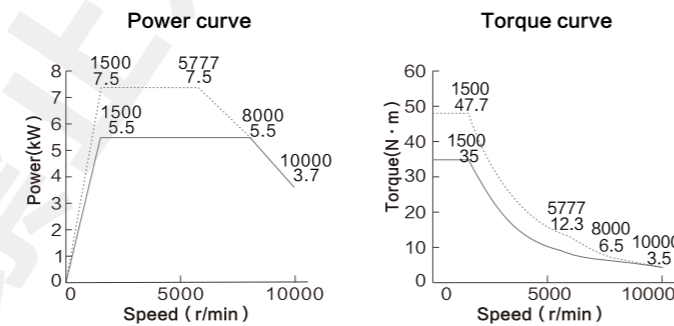

ZJY208A-3.7WL

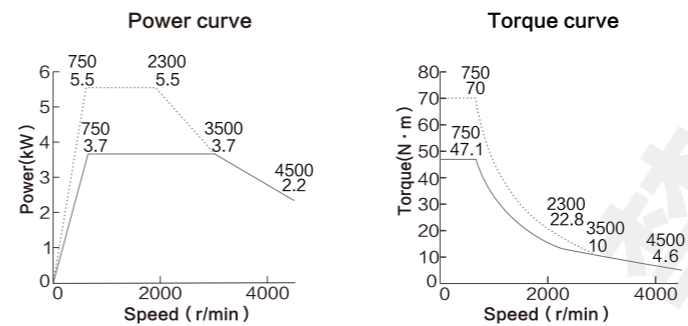

ZJY208A-5.5BL

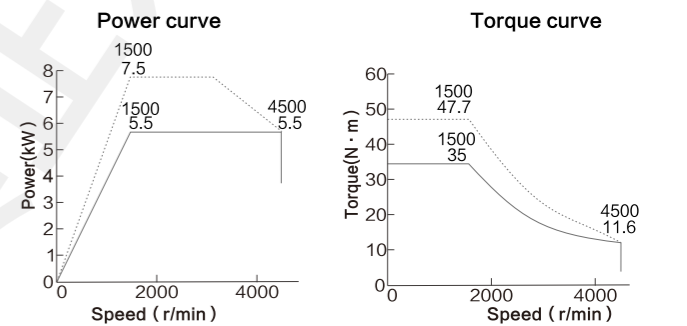

ZJY182A-1.5BH

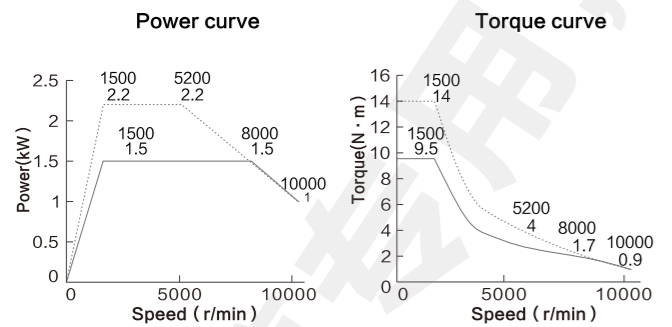

ZJY182A-3.7EG

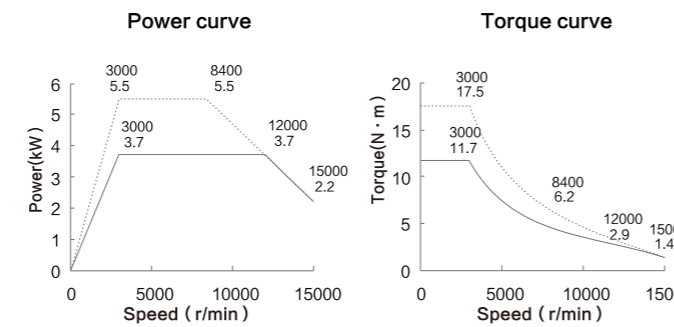

ZJY208A-2.2AM

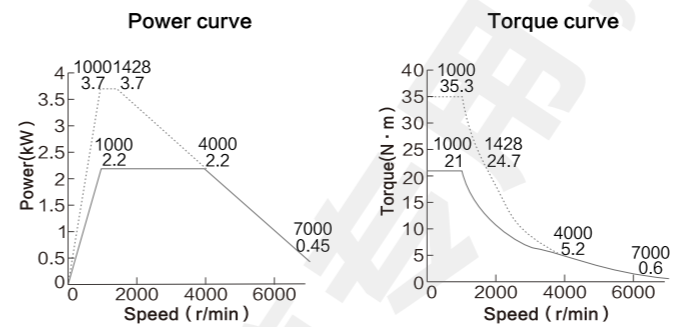

ZJY208A-7.5BL

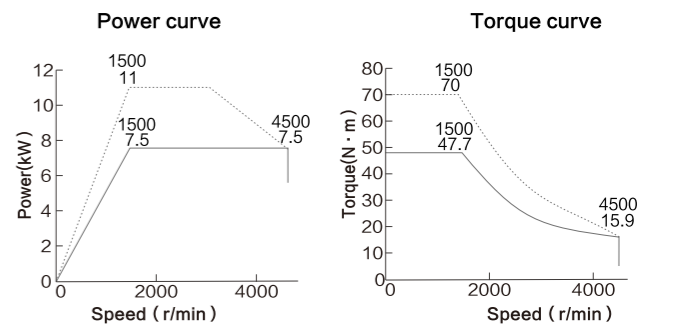

ZJY182A-2.2BH

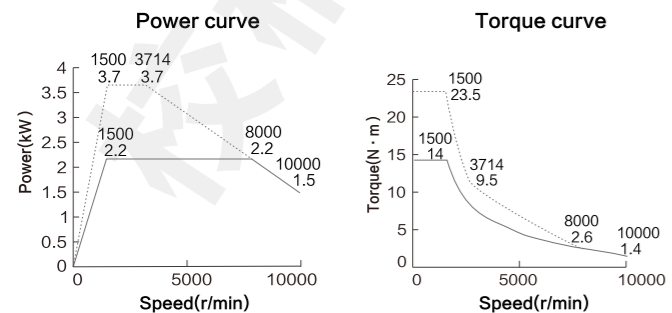

ZJY182A-5.5EG

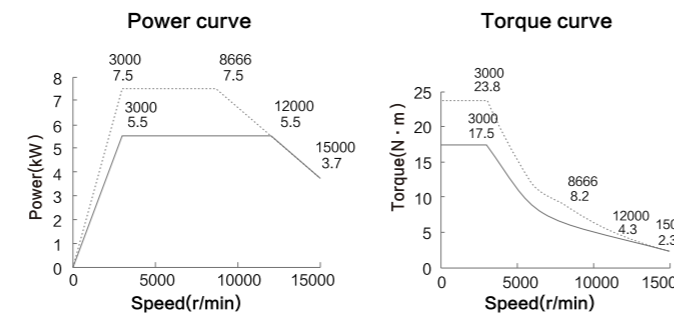

ZJY208A-3.7AM

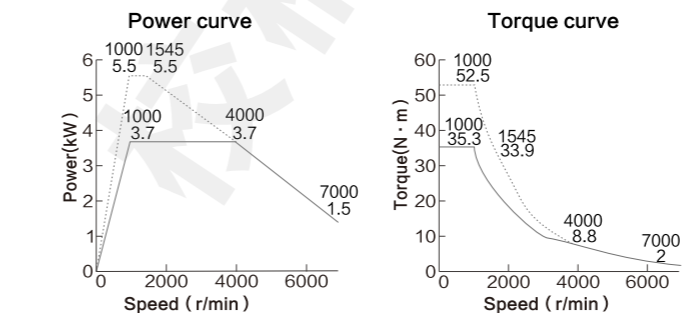

ZJY208A-9BL

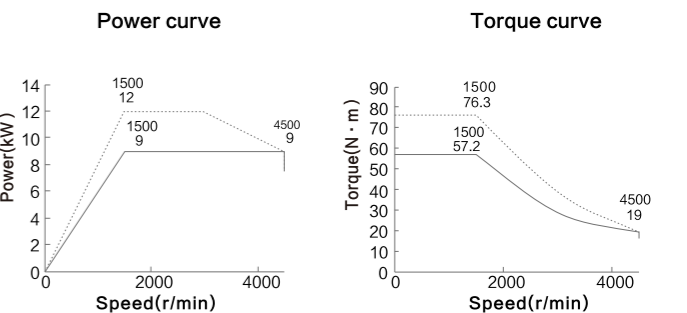

## Mechanical characteristics curve of the motor

## Mechanical characteristics curve of the motor

— Power or torque in the continuous working state;

---- Power or torque in 30min working state.

ZJY208A-3.7BM

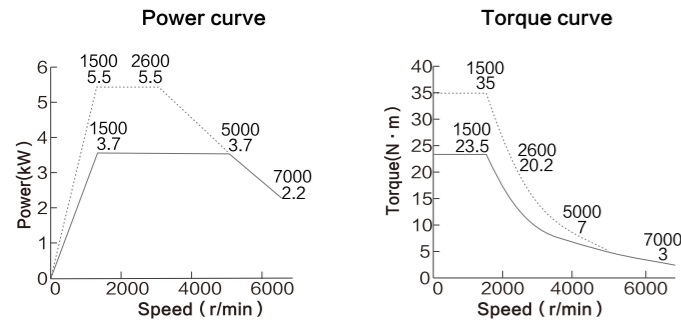

ZJY208A-3.7BH

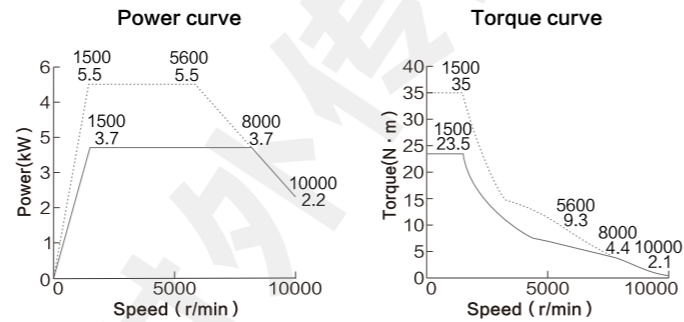

ZJY208A-11CH

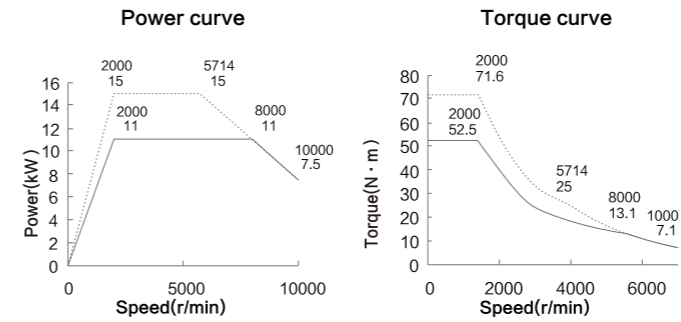

ZJY208A-5.5EF

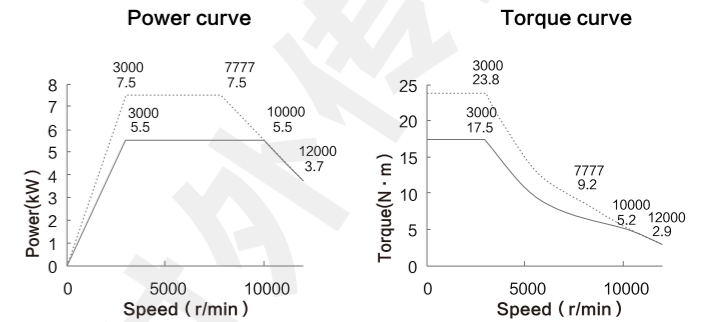

ZJY208A-5.5BM

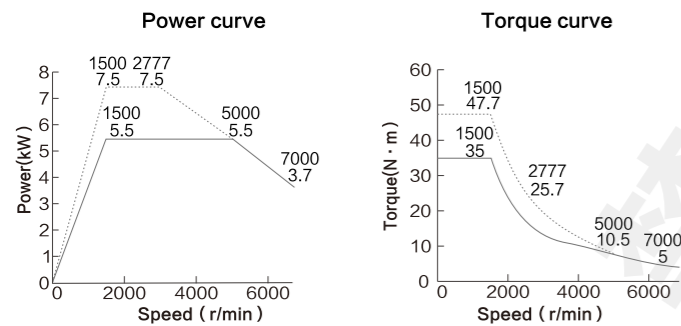

ZJY208A-5.5BH

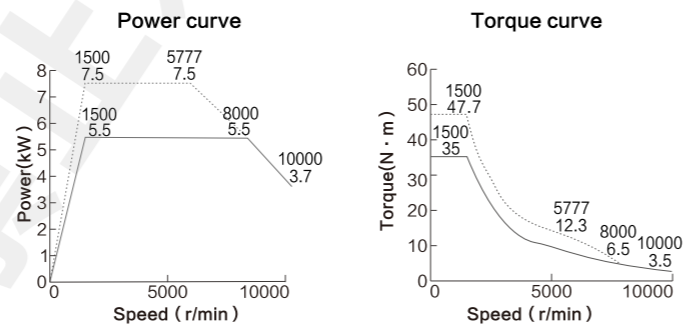

ZJY208A-5.5CF

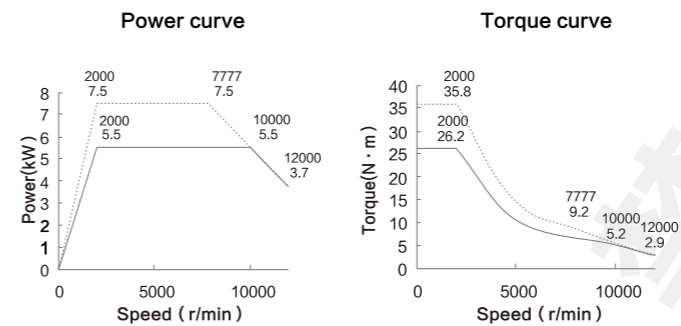

ZJY208A-7.5EF

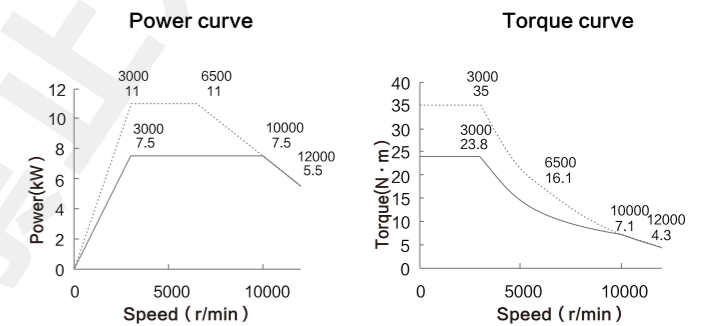

ZJY208A-7.5BM

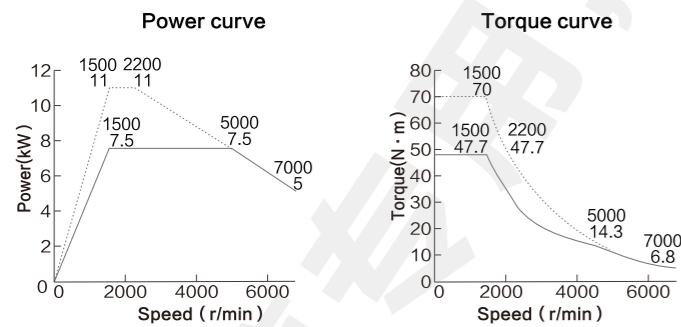

ZJY208A-7.5BH

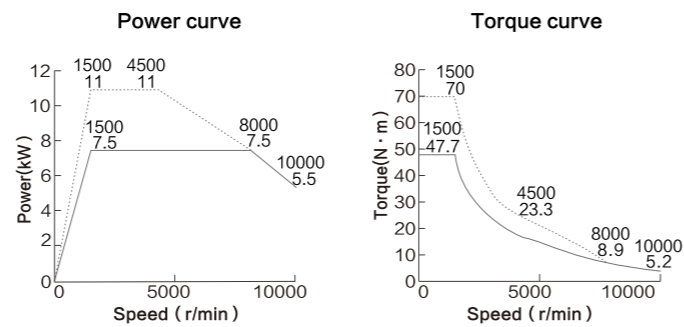

ZJY208A-7.5CF

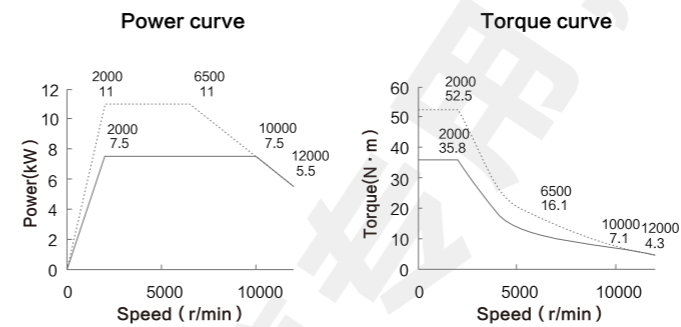

ZJY208A-11EF

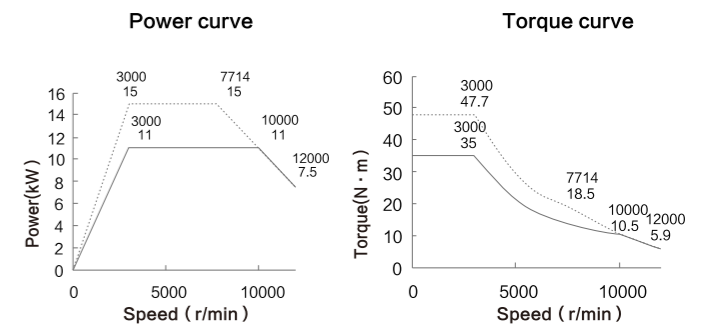

ZJY208A-2.2BH

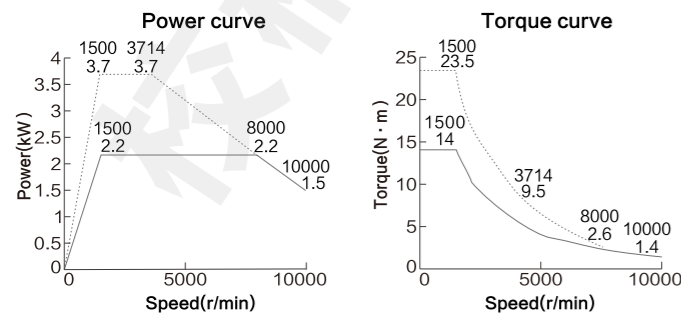

ZJY208A-11CM

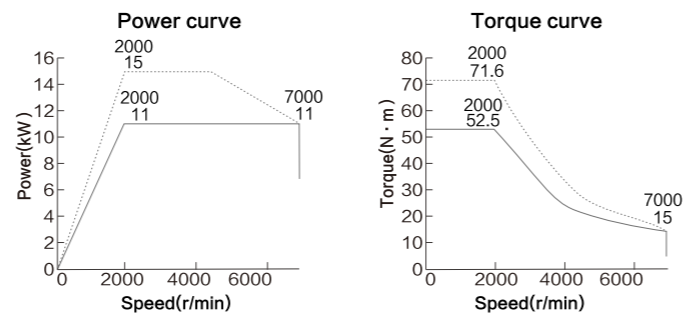

ZJY208A-11EH

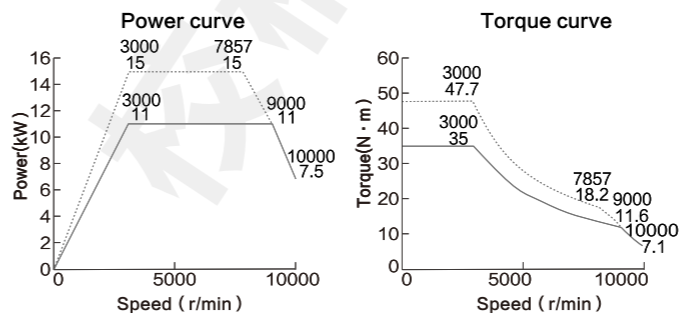

ZJY265A-5.5WL

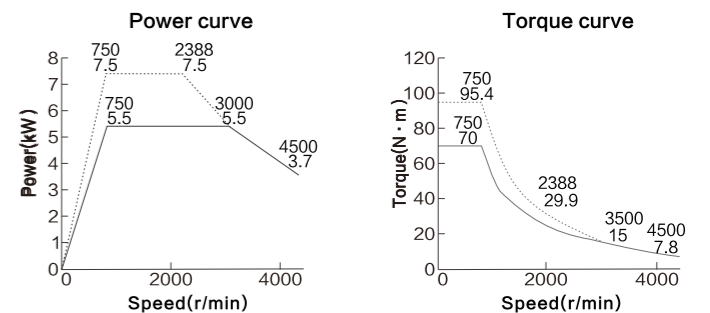

## Mechanical characteristics curve of the motor

## Mechanical characteristics curve of the motor

— Power or torque in the continuous working state;

---- Power or torque in 30min working state.

ZJY265A-7.5WL

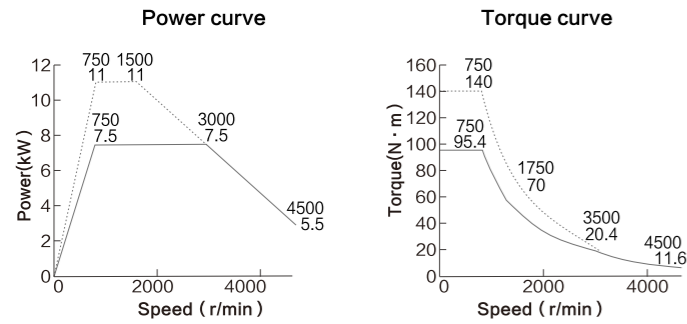

ZJY265A-15AM

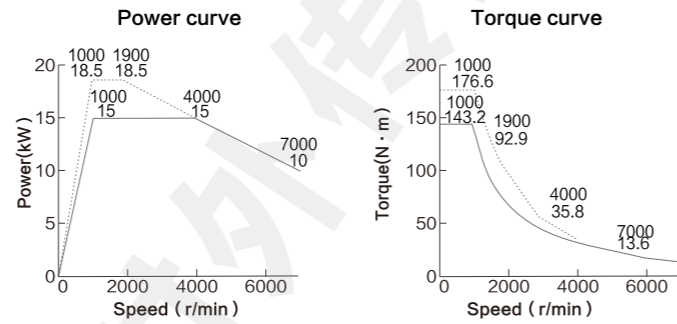

ZJY265A-18.5BM

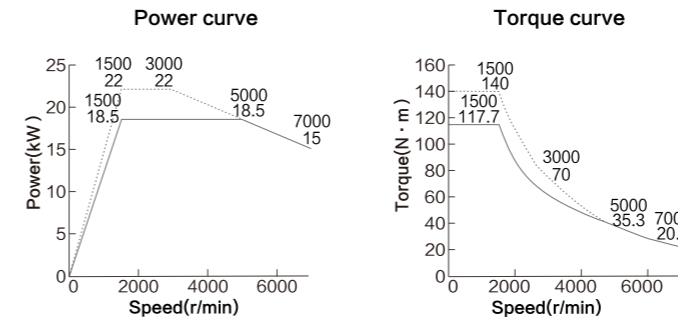

ZJY265A-15BH

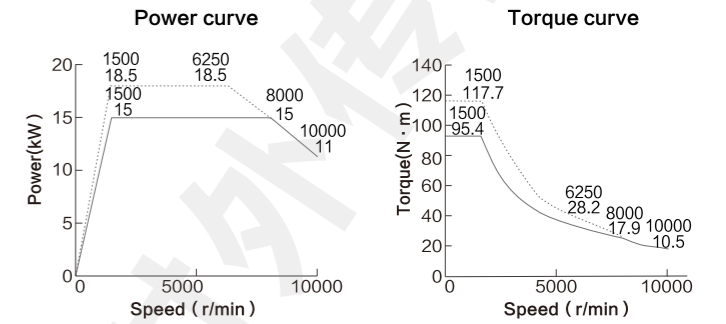

ZJY265A-11WL

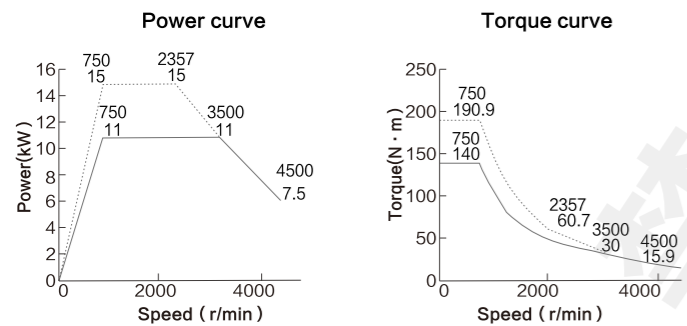

ZJY265A-7.5BM

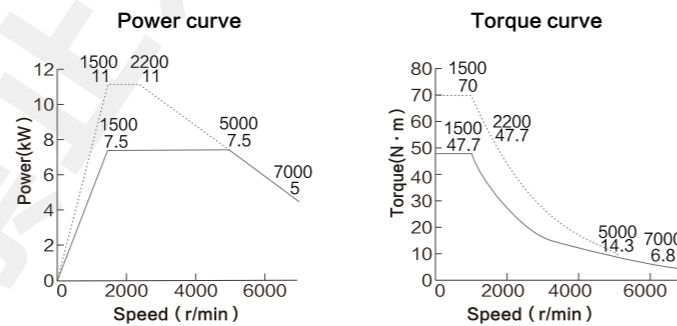

ZJY265A-22BM

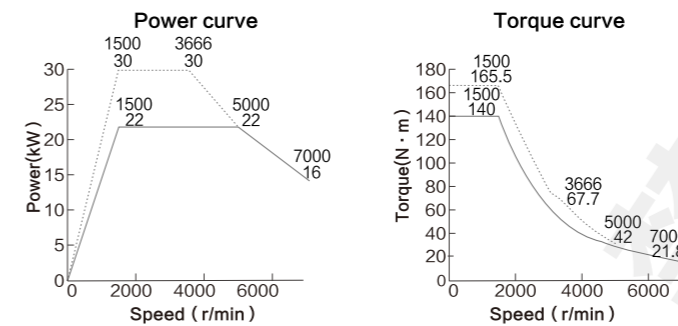

ZJY320-18.5WL

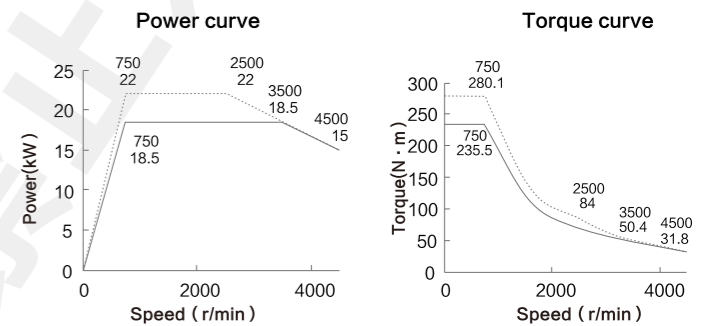

ZJY265A-7.5AM

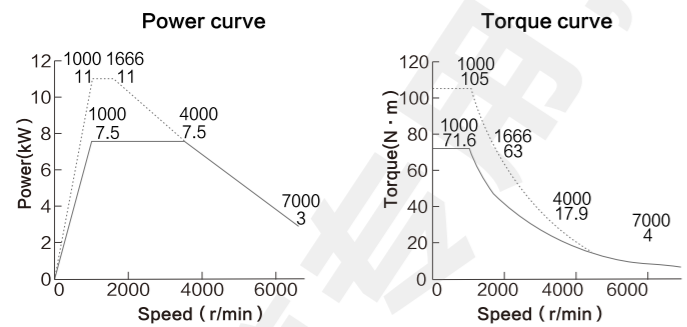

ZJY265A-11BM

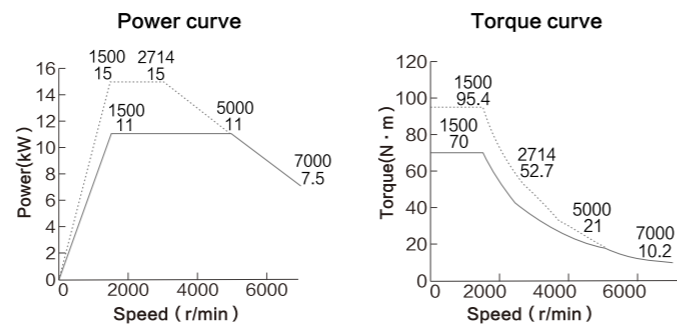

ZJY265A-7.5BH

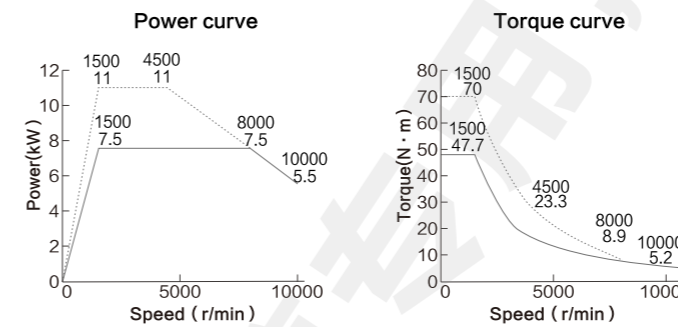

ZJY320-22WL

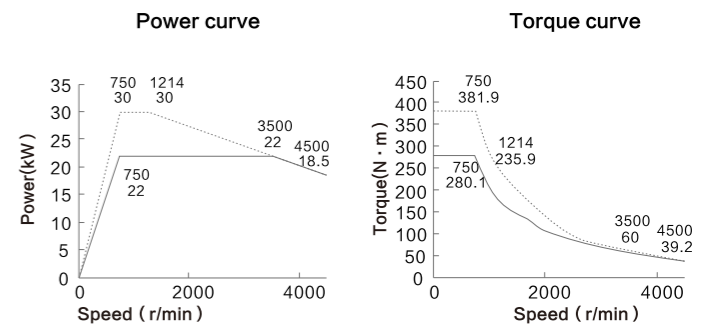

ZJY265A-11AM

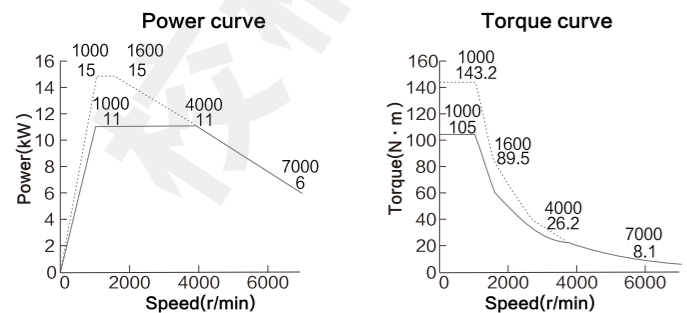

ZJY265A-15BM

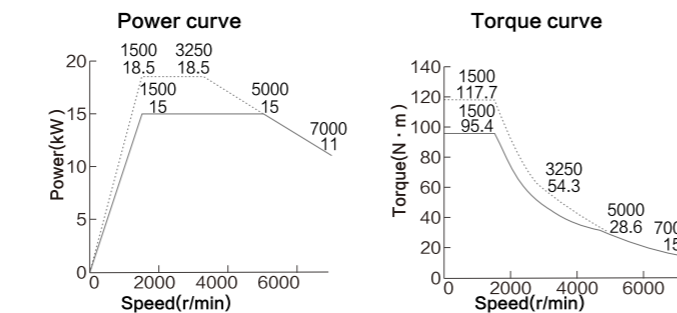

ZJY265A-11BH

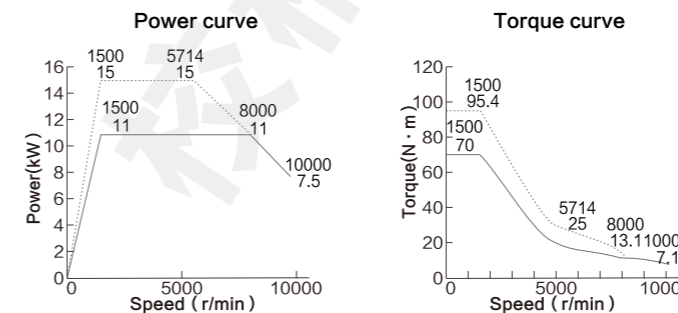

ZJY320-30BL

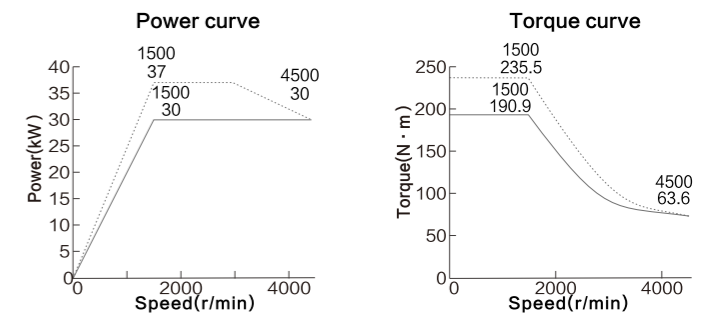

## Mechanical characteristics curve of the motor

## Mechanical characteristics curve of the motor

— Power or torque in the continuous working state;

---- Power or torque in 30min working state.

ZJY320-37BL

ZJY320-45BL

ZJY265A-9VMD (YConnection Mode)

ZJY265A-9VMD (ΔConnection Mode)

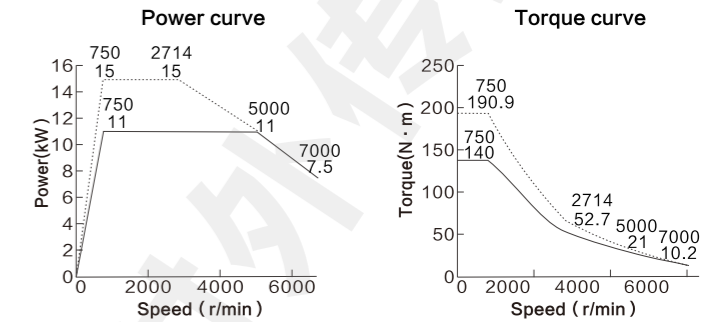
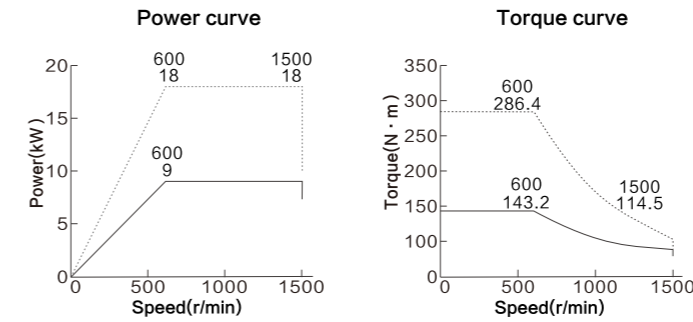
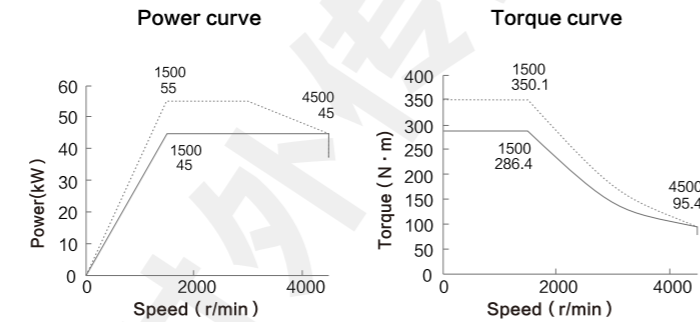
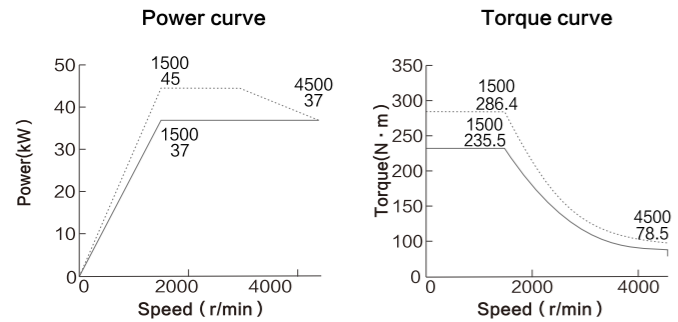

ZJY265A-4.4VMD (YConnection Mode)

ZJY265A-4.4VMD (ΔConnection Mode)

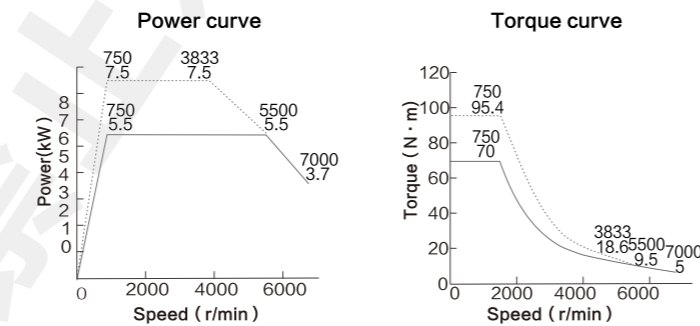
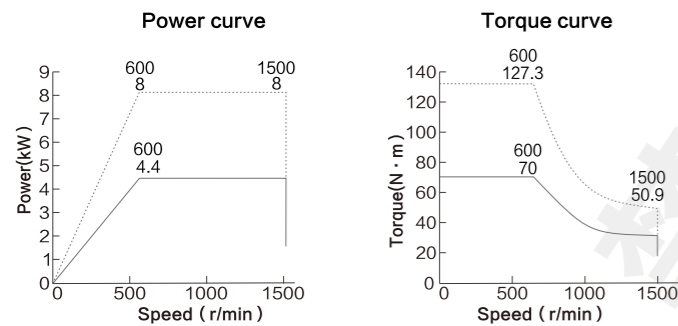

ZJY265A-6VMD (YConnection Mode)

ZJY265A-6VMD (ΔConnection Mode)

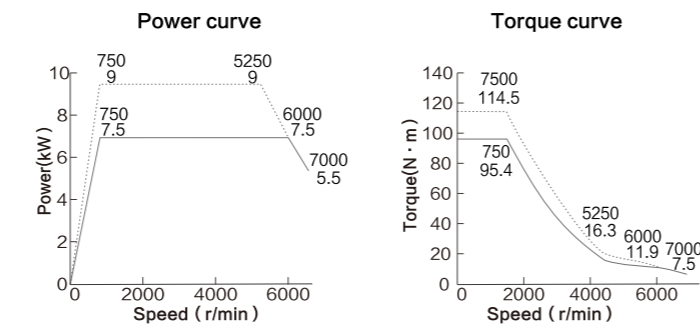
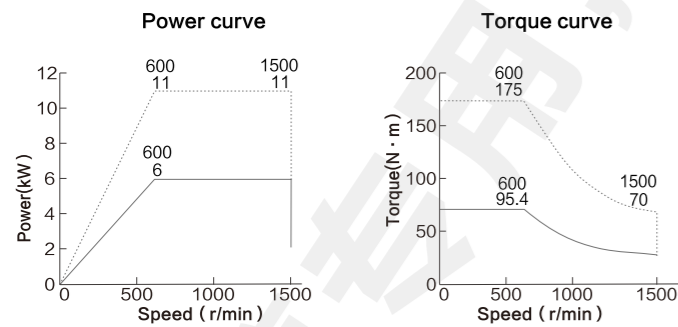

ZJY265A-7.5VMD (YConnection Mode)

ZJY265A-7.5VMD (ΔConnection Mode)

